



Camden

OVERALL DIMENSIONS

36'-0" x 48'-0"



ENERGY WISE HOMES

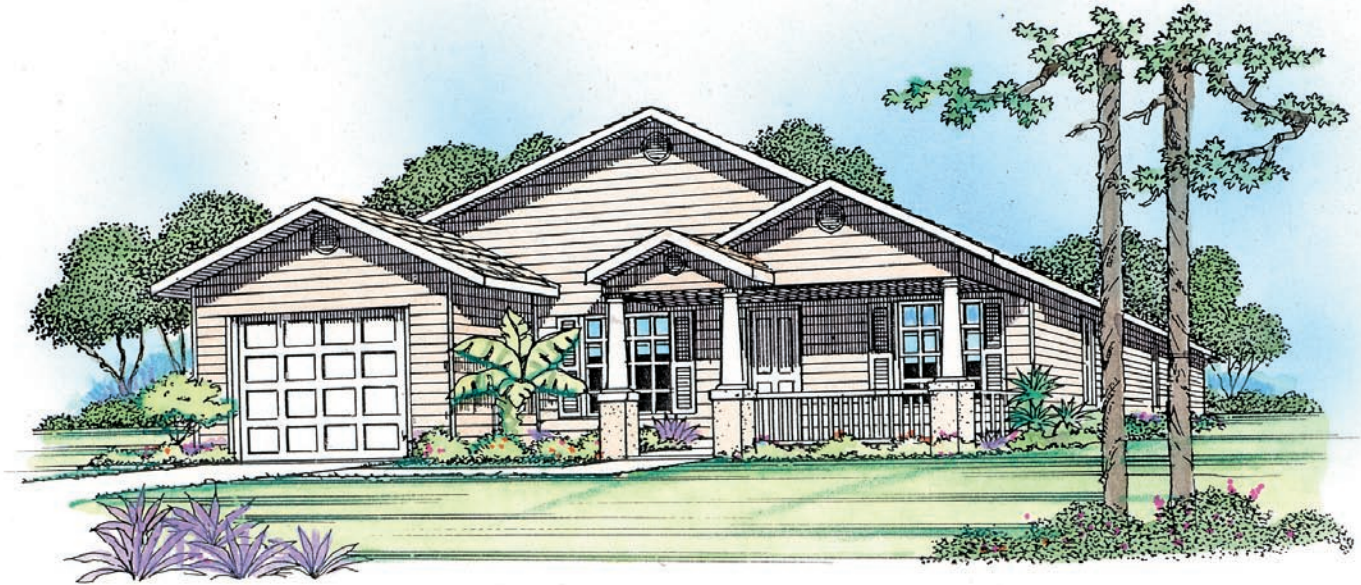

Multiple gable roof lines give the home depth and character and the front porch provides the perfect spot to relax outside with family and friends. The interior four bedroom layout offers ample space for a large family.

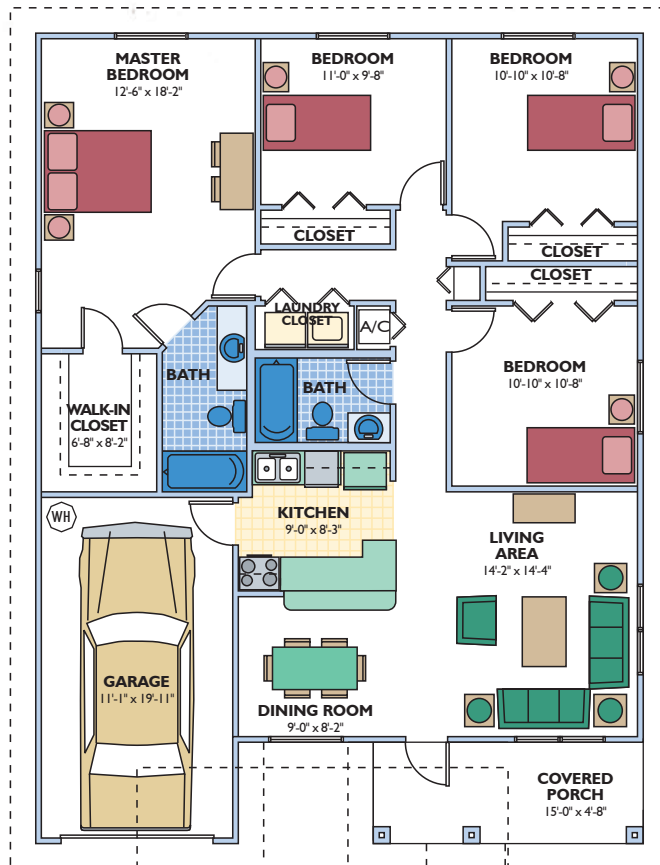

TOTAL LIVING AREA - 1,354 SQ. FT.

4 bedroom, 2 bath, 1 car garage

Structall offers a complete line of precut and preengineered home and building packages utilizing structural insulated panel technology (SIPs). All packages erect quickly, are stronger than conventional framing and extremely energy efficient. SIPs can be clad in conventional OSB or in steel incorporating the patented Snap-N-Lock panel connection.

Snap-N-Lock™ Insulated Panel

Your Choice of Aluminum or Steel Skins

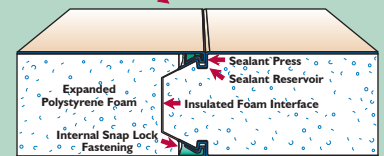

Patent No.'s 4,769,963 and 5,086,599

Metal Chemically Bonded to Foam

Dual Plywood Spline Joint

7/16" Nail Base Oriented Strand Board

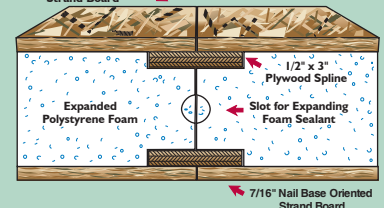

Plans and specifications are subject to change without notice. All dimensions are approximate.